



EVAC+CHAIR®

**Emergency Stairway Descent
for the Mobility Impaired**

1-314-UK/06

Evac+Chair International Ltd +44 (0)121 706 6744 Fax +44 (0)121 706 6746 info@evacchair.co.uk www.evacchair.co.uk

**Presented by PT ELJE PERDANA
Exclusive Distributor For Indonesia**

www.elje4escape.com



Evac+Chair International Limited

Leading Manufacturer of Evacuation Chair

Evac+Chair 25 years of development

More than 30 distributors worldwide

PT ELJE PERDANA is the authorised distributor in Indonesia

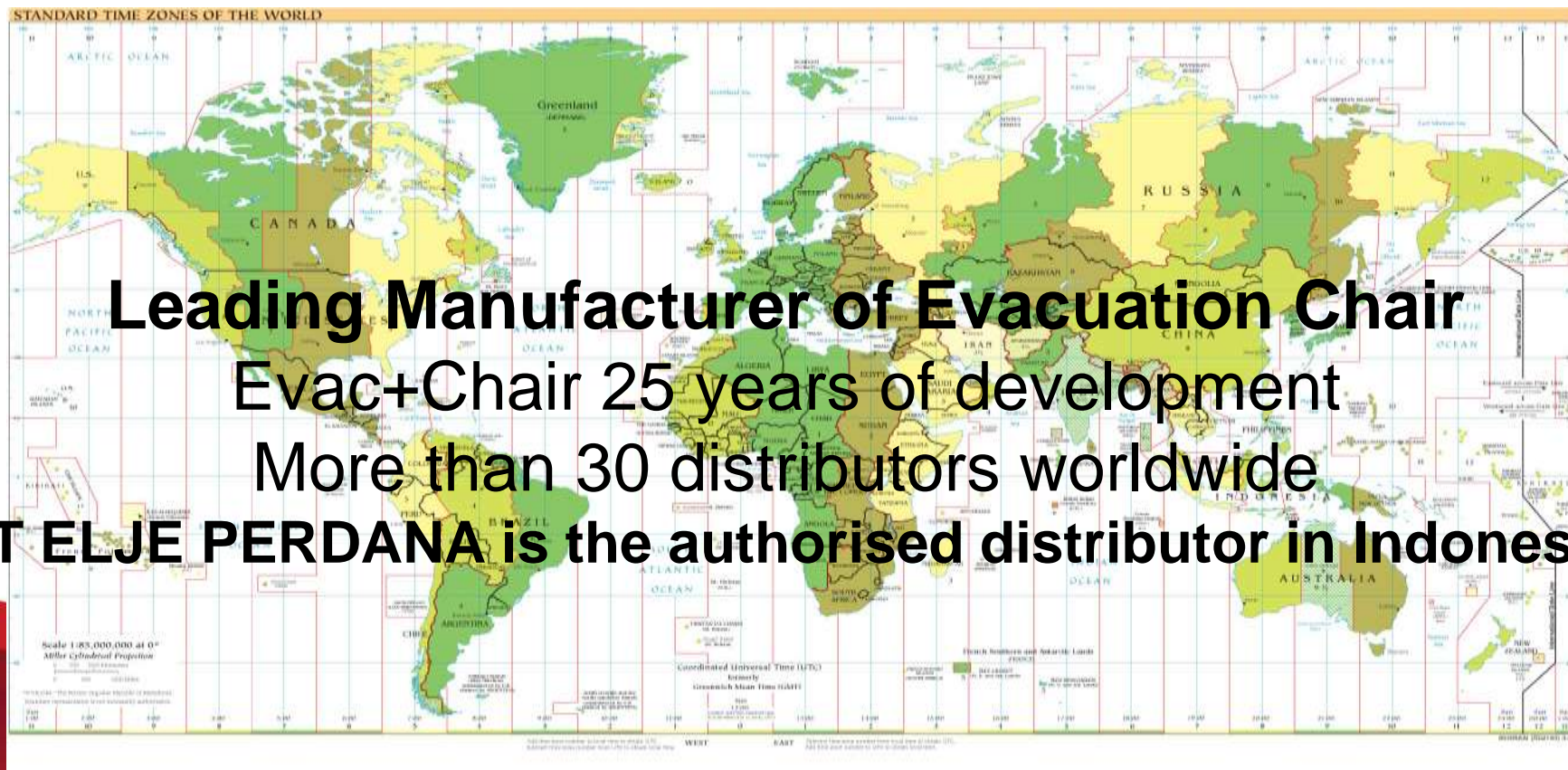

When should you evacuate?



- You should evacuate when the alarm goes off
- (unless it is an alarm test)
- regardless of the type and level of threat

In all cases of high rise evacuation

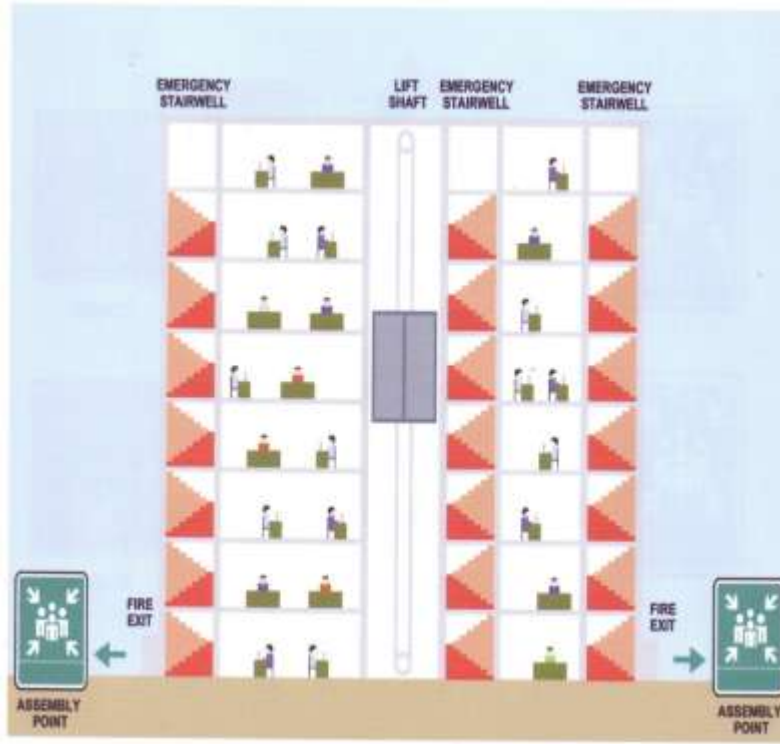

- About 20% of people (or 1 in every 5 persons)
- With permanent or temporary inability to walk down the stairs independently
- Even when the stairways are not hampered
- Due to fear or one form of disability and old-aged



In an Emergency Evacuation have you made provision for:



- **Mobility Impaired**
- **Injured Personnel**
- **Blind**
- **Deaf**
- **Angina Sufferers**
- **Epileptics**
- **Elderly**
- **Pregnant Women**
- **Arthritic**

Is it acceptable to leave persons with mobility impaired behind?



- A sprinklered floor of a building provides sufficient protection to be considered an area of refuge
- People without disabilities evacuate the building



The concept of “Equal Opportunity in Evacuations”



**Recognised the fact that
“No One Should Be Left
Behind”**

**in the event of a large
scale mass evacuation**



No One Should Be Left Behind

IT CAN HAPPEN ANY DAY!

ARE YOU PREPARED FOR:

- **FIRE HAZARD**
- **LIFTS OUT OF ORDER**
- **BOMB ALERT**
- **SMOKE WARNING**
- **EVACUATION OF PERSONNEL**
- **BUILDING PROBLEM**
- **MANAGEMENT SOLUTION**
- **CONSULTATION**
- **TRAINING**
- **AFTER SALES SERVICE**
- **SOLVING PROBLEMS . . . SAVES LIVES**

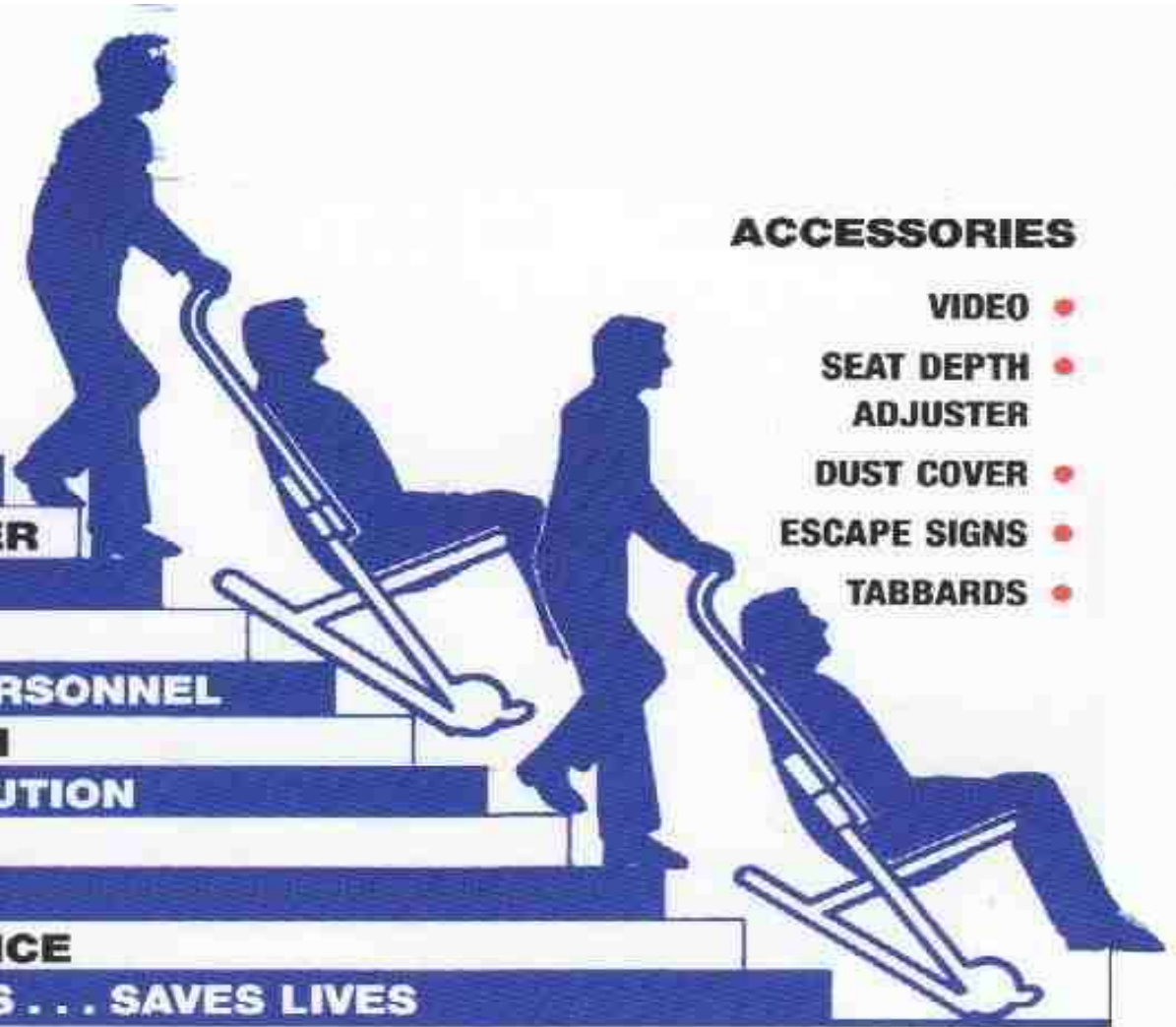

ACCESSORIES

- VIDEO** •
- SEAT DEPTH ADJUSTER** •
- DUST COVER** •
- ESCAPE SIGNS** •
- TABBARDS** •



is an evacuation chair

- **A universal evacuation solution for smooth stairway descent during an emergency**
- **Single user operation, light weight and easy to use for people who are mobility impaired in the event of an evacuation of multi-storey buildings**

Target Customer Profile

- **Government and government agencies**
- **Large corporate companies, especially banks and other financial institution**
- **Hotels, especially the glamorous and the luxurious ones**
- **People with disabilities who are employed in multi-storey buildings (can persuade employers to buy)**



Evac+Chair are used in

- Hospitals
- Schools
- Universities
- Banks & Insurance
- Local Authorities
- Sports Stadiums
- Hotels
- Malls
- Offices
- Leisure Centres
- Public Buildings
- Entertainment Centres
- Homes
- Factories
- Emergency Services



Some of EVAC+CHAIR's Customers



JAGUAR • DAIMLER
HERITAGE TRUST



DFID Department for
International
Development

HARVEY NICHOLS



UNIVERSITY OF
CAMBRIDGE





Why do they need EVAC+CHAIR?

- Primarily because of people with disabilities working for the organisation**
- Helps meet the duty of care under Health & Safety and Disability Discrimination Legislation**
- Corporate value – “No one should be left behind in an emergency evacuation”**

NOTICE TO VISITORS

If you have a condition that might restrict your ability to use the stairs in an emergency, please mention this in confidence to your host.

Arrangements can then be put in hand to ensure your speedy and safe evacuation should such an emergency occur.



Thank you for your
co-operation.



Change was needed.

RRfsO + PEEP



Personal Emergency Evacuation Plan (PEEPS)



- **Basic info. and Example.**
- **From Alarm till Assembly**
- **Wheelchair user**
- **Buddy's (same floor)**
- **Transfer into Evac+Chair**
- **Preferred route**
- **Assembly point?**
- **After the evacuation**
- **HM Government guide
(light weight evac chairs)**

Change might be necessary !



EVAC+CHAIR Models



EVAC+CHAIR
300H

EVAC+CHAIR
**300H
AMB**



EVAC+CHAIR
600H



IBEX TRANSEAT
700H



EVAC+CHAIR 300H

- **Single Person Operation**
- **Width** 52cm
- **Height folded** 104cm
- **Height extended** 150cm
- **Depth overall** 80cm
- **Depth folded** 20cm
- **Weight** 9.8kg
- **Payload** 150kg





EVAC+CHAIR 300H AMB

- Standard model Evac+Chair with larger heavy duty rear wheels for ambulance
- Single Person Operation
- Width 52cm
- Height folded 104cm
- Height extended 150cm
- Depth overall 80cm
- Depth folded 20cm
- Weight (unladen) 10.5kg
- Payload 150kg



EVAC+CHAIR 600-H



- With two extra handles
- Two persons operation
- Lifting capability for difficult access
- Width 60cm
- Height folded 120cm
- Height extended 150cm
- Depth overall 80cm
- Depth folded 30cm
- Weight (unladen) 11kg
- Payload 150kg

IBEX TranSeat 700H



- Descends and ascends stairs without carrying or heavy lifting
- Single person operation
- Width 46cm / 40cm*
- Height folded 110cm
- Depth folded 36cm
- Weight (unladen) 14.5kg / 14.4kg*
- Payload 159kg
- * *Narrow aisle model option*

AIR+CHAIR



- **On-board transit chair to facilitate the transfer of air passengers safely in an emergency**
- **Folded design allows for the chair to be manoeuvred on its own castor wheels without the need to lift**



EVAC+CHAIR Accessories



Alarm/Anti-Theft Device



**Self-
Standing
Stand**



Cover



**Wall-
Mounted
Cabinet**

Optional Items can be purchased separately



EVAC+CHAIR Accessories



Alarm/Anti-Theft Device



**Self-
Standing
Stand**



Cover



**Wall-
Mounted
Cabinet**

Optional Items can be purchased separately



EVAC+CHAIR Storage



Optional Items can be purchased separately



EVAC+CHAIR Comfy Seat



- A cushion seat which provides additional comfort and support



- The Comfy Seat clips to the seat frame of the EVAC+CHAIR and can be purchased as retrofit

Optional Items can be purchased separately



EVAC+CHAIR Patient Carrier Seat



- A portable transfer device for lifting incapacitated person from wheelchair into or out of an EVAC+CHAIR, where self-transfer is difficult

Optional Items can be purchased separately



EVAC+CHAIR MiniStretcher



- For lifting patients, bed to bed transfer, transferring incapacitated persons into EVAC+CHAIR
- Not intended for use over long distances or as substitute for the EVAC+CHAIR

Optional Items can be purchased separately



EVAC+CHAIR Reception Notice



A framed notice to visitors to a building reminding them of their responsibilities in an emergency evacuation

Optional Items can be purchased separately



Evac+Chair International Limited doesn't sell evacuation chair, it sells experience and solution that goes with the Evac+Chair



PT ELJE PERDANA provides after sales support for Evac+Chair in INDONESIA



After Sales Support

- **Trainings in the proper use of Evac+Chairs**
- **Consultation for optimise the number of chairs in buildings**
- **Consultation for integrated solution to building evacuation - supplemental evacuation**
- **Evacuation Procedures in Personal Emergency Evacuation Plan**
- **ServiCare – maintenance & replacement parts**

PT ELJE PERDANA provides ServiCare for customers in INDONESIA



Purchasing Criteria

Buying a non-genuine EVAC+CHAIR

- At a lower price may put your operator and passengers at risk and cost more in the long run.
- When evaluating your intended purchase try before you buy, and beware of imitations.
- They may look the same from a picture but the construction and functionality may vary.



Consider these criteria:

[Deployment](#)

[Weight of Unit](#)

[Ease of Transfer](#)

[Manoeuvrability](#)

[Speed of Descent](#)

[Controlled Speed of Descent](#)

[Assembly Point](#)

[After-Sales Support](#)

[Accreditation](#)

**If you are unsure your intended purchase is a genuine EVAC+CHAIR,
contact your authorised local distributor or visit website
www.evacchair.net**



PT ELJE PERDANA

**An integrated solutions provider for building evacuation
– supplemental evacuation:**

- **EVAC+CHAIR** www.evacchair.net
- **INGSTROM Escape Chute** www.mobiltex.se
- **SAL Self-Rescue System** www.sal-int.com
- **Ecoglo (Glow-In-The-Dark)** www.ecoglo.com

- **If you want to contact us,
please email us at:** elje@centrin.net.id

**If you want to know more about PT ELJE PERDANA,
please visit website: www.elje4escape.com**



Thank You